

FIFTH AMENDMENT TO SOUTHCOVE MASTER DEED  
EXHIBIT "B", CONDOMINIUM SUBDIVISION PLAN 15

Condominium Subdivision Plans, being Exhibit "B", are hereby amended as follows:

"Add forty-one (41) units numbered 38, 39, 40, 41, 42, 47, 48, 49, 50, 55, 56, 57, 58, 61, 62, 63, 64, 65, 79, 80, 81, 82, 83, 84, 85, 86, 87, 88, 89, 90, 91, 92, 93, 94, 95, 96, 97, 98, 99, 100, and 101."

The new units described above are as shown on the attached Amended Condominium Subdivision Plan which is made a part hereof. This Amendment does alter the percentage of value assigned to any unit in Southcove and does change the allocable expenses and/or percentage interest of any value assigned to each unit as computed in accordance with Article V of the Master Deed.

The number of units as referred to in Article V (c) shall be 90 units and each of said units shall be considered to have a percentage of value as indicated on attached Exhibit I.

This Amendment is submitted in accordance with the authority given New Buffalo Harbor, Inc., a Michigan corporation, as developer, by Public Act 59 of 1978 as amended; as directed by a vote of the Board of Directors to amend the Master Deed to accomplish the inclusion of said units in The Southcove Association and by the consent of the developer to said Amendment which is also attached hereto and made a part hereof, in accordance with Article IX of the Master Deed previously filed and approved.

This Amendment shall be effective immediately upon its filing with the Register of Deeds Office, Berrien County, Michigan.

Dated: June 8, 1987.

In the Presence of:

NEW BUFFALO HARBOR, INC.

Ellen C. Van Brocklin  
Ellen C. Van Brocklin

By: James L. Stevens  
James L. Stevens  
President

Margaret O'Neill  
Margaret O'Neill

By: Rocco M. DeFrancesco  
Rocco M. DeFrancesco  
Secretary

17 of 11-62-0004-14-2  
17 of 11-62-0340-0050-02-9

11-62-7151  
7152  
7153  
7154

I HEREBY CERTIFY, That there are no Tax Liens or Title held by the State or any individual against the within description and all Taxes on same are paid for five years previous to the date of this instrument, as appears by the records in my office. This certificate does not apply on taxes, if any, now in process of collection. Also except, Deferred Special Assessments, if any, under Act No. 225, Public Acts of 1976, as amended.  
Berrien County Treasurer

Carol Starkman  
Date 6/10/87  
No. 2267

RECORDED

JUN 10 3 10 PM '87

LIBER 15 PAGE 95

Christine J. ...  
REGISTER OF DEEDS  
BERRIEN COUNTY, MICHIGAN

STATE OF MICHIGAN )  
 ) ss.  
COUNTY OF BERRIEN )

On this 8th day of June, 1987, the foregoing instrument was acknowledged before me by James L. Stevens, President of New Buffalo Harbor, Inc., and Rocco M. DeFrancesco, Secretary of New Buffalo Harbor, Inc., a Michigan corporation, on behalf of the corporation.

  
Ellen C. Van Brocklin, Notary Public  
Berrien County, Michigan  
My commission expires: 9/16/89

**PREPARED BY:**

Rocco M. DeFrancesco  
903 Main Street  
St. Joseph, MI 49085

EXHIBIT I TO  
FIFTH AMENDMENT TO MASTER DEED

The following is a schedule of units and the percentage of value assigned to each unit:

| <u>PERCENTAGE OF VALUE</u> |        |      |      |
|----------------------------|--------|------|------|
| 1.                         | 1.45   | 38.  | 0.63 |
| 2.                         | 1.45   | 39.  | 0.63 |
| 3.                         | 2.18   | 40.  | 0.63 |
| 4.                         | 1.25   | 41.  | 0.63 |
| 5.                         | 1.25   | 42.  | 0.71 |
| 6.                         | 1.83   | 47.  | 0.35 |
| 7.                         | 1.83   | 48.  | 0.35 |
| 8.                         | 1.45   | 49.  | 0.35 |
| 9.                         | 1.45   | 50.  | 0.35 |
| 10.                        | 2.18   | 55.  | 0.40 |
| 11.                        | 1.83   | 56.  | 0.40 |
| 12.                        | 1.83   | 57.  | 0.40 |
| 13.                        | 1.45   | 58.  | 0.42 |
| 14.                        | 1.45   | 61.  | 0.40 |
| 15.                        | 2.18   | 62.  | 0.40 |
| 16.                        | 1.83   | 63.  | 0.40 |
| 17.                        | 1.83   | 64.  | 0.40 |
| 18.                        | 1.45   | 65.  | 0.42 |
| 19.                        | 1.45   | 79.  | 0.76 |
| 20.                        | 2.18   | 80.  | 0.76 |
| 21.                        | 1.25   | 81.  | 0.76 |
| 22.                        | 1.25   | 82.  | 0.76 |
| 23.                        | 1.83   | 83.  | 0.66 |
| 24.                        | 1.83   | 84.  | 0.76 |
| 25.                        | 1.25   | 85.  | 0.76 |
| 26.                        | 1.25   | 86.  | 0.76 |
| 27.                        | 1.25   | 87.  | 0.76 |
| 28.                        | 1.25   | 88.  | 0.76 |
| 32.                        | 3.79   | 89.  | 0.76 |
| 33.                        | 3.79   | 90.  | 0.69 |
| 34.                        | 3.79   | 91.  | 0.57 |
| 35.                        | 3.79   | 92.  | 0.57 |
| 36.                        | 3.79   | 93.  | 0.64 |
| 37.                        | 3.79   | 94.  | 0.63 |
| 45.                        | 0.35   | 95.  | 0.40 |
| 46.                        | 0.35   | 96.  | 0.40 |
| 53.                        | 0.40   | 97.  | 0.40 |
| 54.                        | 0.40   | 98.  | 0.40 |
| 68.                        | 0.85   | 99.  | 0.40 |
| 69.                        | 0.76   | 100. | 0.40 |
| 70.                        | 0.76   | 101. | 0.42 |
| 71.                        | 0.76   |      |      |
| 72.                        | 0.76   |      |      |
| 73.                        | 0.66   |      |      |
| 74.                        | 0.76   |      |      |
| 75.                        | 0.76   |      |      |
| 76.                        | 0.76   |      |      |
| 77.                        | 0.76   |      |      |
| 78.                        | 0.76   |      |      |
| <hr/>                      |        |      |      |
| TOTAL                      | 100.00 |      |      |

CONSENT BY DEVELOPER TO FIFTH  
AMENDMENT TO SUBDIVISION PLAN  
OF EXHIBIT B AND OTHER PROVISIONS

The undersigned, being the developer of Southcove, a condominium in Berrien County, Michigan, hereby consents to the modification to the drawings, pages number X-1433-1, X-1433-2, X-1433-3, X-1433-4, X-1433-5 and X-1433-12, of the Condominium Subdivision Plan (Exhibit B to the Master Deed) and to the other provisions included in the amendment.

Dated: June 8, 1987.

NEW BUFFALO HARBOR, INC.

In the Presence Of:

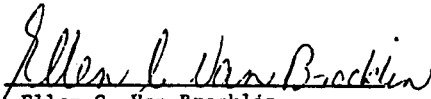
  
Ellen C. Van Brocklin

  
Margaret O'Neill

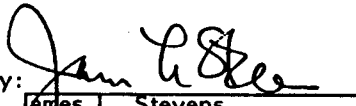
By:   
James L. Stevens  
President

By:   
Rocco M. DeFrancesco  
Secretary

NBH-1/6-8-87











**GENERAL NOTATIONS FOR UNITS 1-32**  
 UNITS 1-32, located in the vicinity of the ...  
 ALL UNITS ARE SERVICED WITH GAS BY THE ...  
 ALL UNITS ARE SERVICED WITH WATER BY THE ...  
 ALL UNITS ARE SERVICED WITH TELEPHONE BY ...  
**GENERAL NOTATIONS FOR ALL UNITS**  
 UNITS 1-32, located in the vicinity of the ...  
 ALL UNITS ARE SERVICED WITH GAS BY THE ...  
 ALL UNITS ARE SERVICED WITH WATER BY THE ...  
 ALL UNITS ARE SERVICED WITH TELEPHONE BY ...

| UTILITY | LEAD                      | SOURCE OF LOCATION           |
|---------|---------------------------|------------------------------|
| CAS     | CABLE TELEVISION          | PLANS PROVIDED BY THE OFFICE |
| SAN     | SEWER SERVICE             | PLANS PROVIDED BY THE OFFICE |
| ST      | STORM SEWER               | PLANS PROVIDED BY THE OFFICE |
| WET     | WATER SERVICE             | PLANS PROVIDED BY THE OFFICE |
| GA      | GAS MAIN                  | PLANS PROVIDED BY THE OFFICE |
| TE      | TELEPHONE                 | PLANS PROVIDED BY THE OFFICE |
| EL      | ELECTRIC                  | PLANS PROVIDED BY THE OFFICE |
| ○       | SANITARY MANHOLE          |                              |
| ●       | WATER VALVE               |                              |
| □       | FIRE HYDRANT              |                              |
| ◇       | ELECTRIC TRANSFORMER      |                              |
| ○       | CATCH BASIN               |                              |
| ●       | METER (UNITS 1-27, 30-32) |                              |

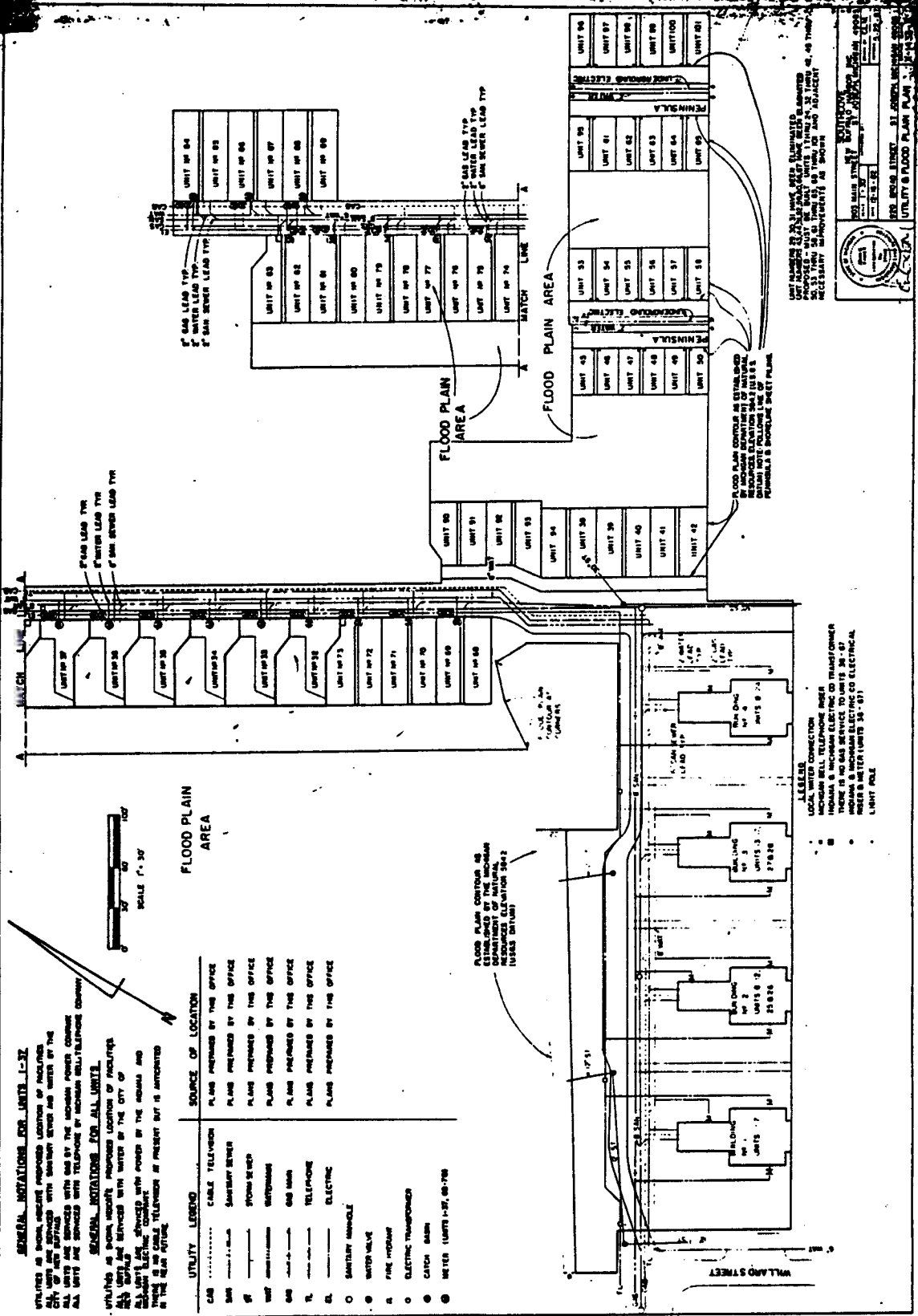

**UTILITY & FLOOD PLAN**  
 UNIT 01  
 UNIT 02  
 UNIT 03  
 UNIT 04  
 UNIT 05  
 UNIT 06  
 UNIT 07  
 UNIT 08  
 UNIT 09  
 UNIT 10  
 UNIT 11  
 UNIT 12  
 UNIT 13  
 UNIT 14  
 UNIT 15  
 UNIT 16  
 UNIT 17  
 UNIT 18  
 UNIT 19  
 UNIT 20  
 UNIT 21  
 UNIT 22  
 UNIT 23  
 UNIT 24  
 UNIT 25  
 UNIT 26  
 UNIT 27  
 UNIT 28  
 UNIT 29  
 UNIT 30  
 UNIT 31  
 UNIT 32

**FLOOD PLAIN AREA**  
 FLOOD PLAIN CONTROL AS ESTABLISHED BY THE ...  
 REDUCED ELEVATION ...  
 DETAIL NOTE FOLLOWING LINE OF ...  
 POSSIBLE IS SHOWN IN DOTTED LINE

**LOCAL WATER CONNECTION**  
 MICHIGAN BELL TELEPHONE ROVER TRANSFORMER  
 THERE IS NO GAS SERVICE TO UNITS 24-27  
 MICHIGAN & MICHIGAN ELECTRIC CO. ELECTRICAL  
 ROVER & METER (UNITS 24-27)  
 UNIT POLE

**FLOOD PLAIN CONTROL AS ESTABLISHED BY THE ...**  
 REDUCED ELEVATION ...  
 DETAIL NOTE FOLLOWING LINE OF ...  
 POSSIBLE IS SHOWN IN DOTTED LINE

**WILLARD STREET**  
 UNIT POLE  
 MICHIGAN BELL TELEPHONE ROVER TRANSFORMER  
 THERE IS NO GAS SERVICE TO UNITS 24-27  
 MICHIGAN & MICHIGAN ELECTRIC CO. ELECTRICAL  
 ROVER & METER (UNITS 24-27)  
 UNIT POLE



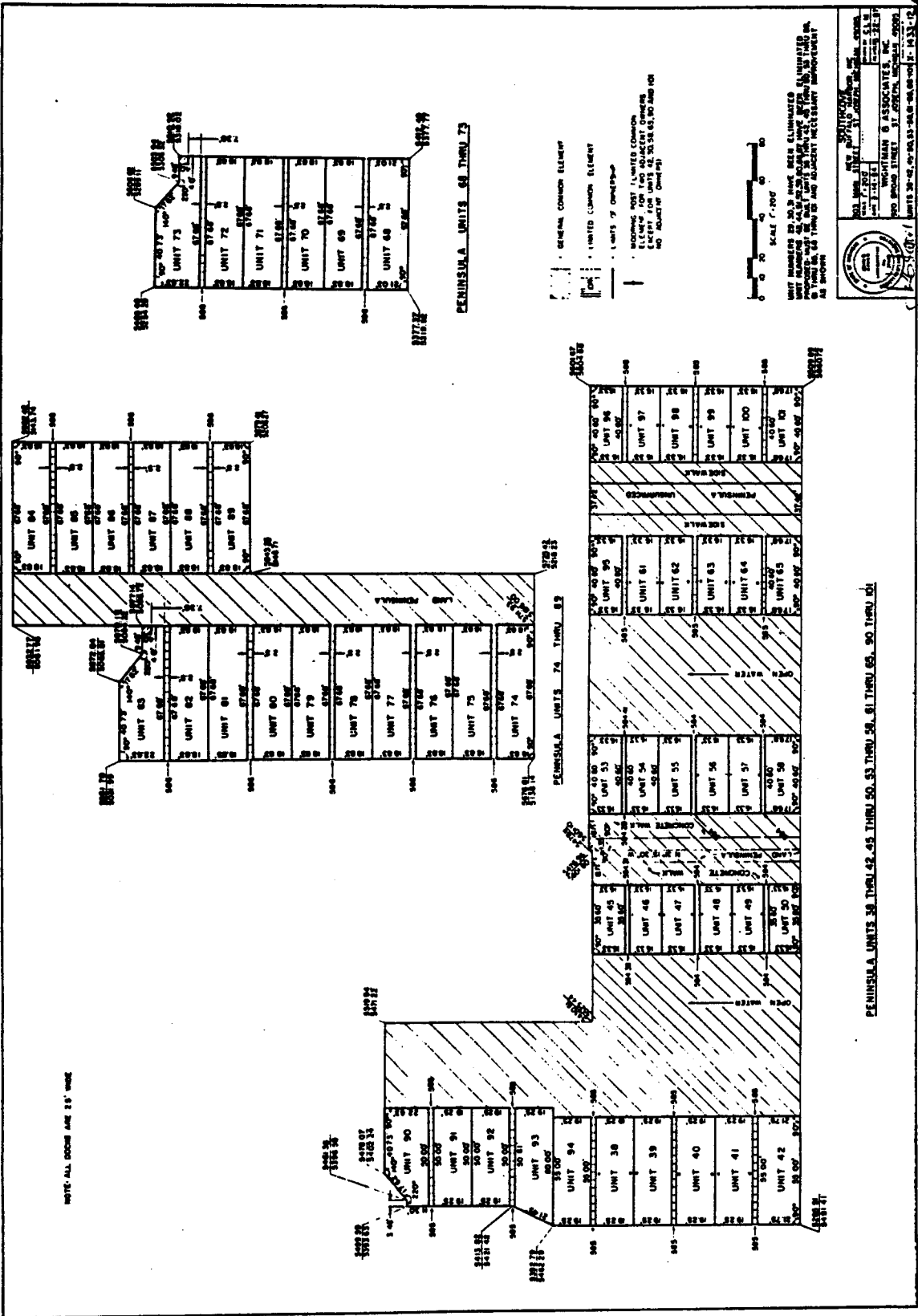

NOTE: ALL DIMENSIONS ARE IN FEET

PENINSULA UNITS 60 THRU 73

- GENERAL COMMON ELEMENT
- UNITED COMMON ELEMENT
- UNITS 70 THROUGH 73
- STAIRING POST (UNITED COMMON ELEMENT) FOR UNITS 60 THROUGH 73
- ELEVATOR FOR UNITS 60 THROUGH 73
- STAIRING POST (UNITED COMMON ELEMENT) FOR UNITS 60 THROUGH 73

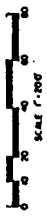

UNIT NUMBERS 60, 61, 62, 63, 64, 65, 66, 67, 68, 69, 70, 71, 72, 73, 74, 75, 76, 77, 78, 79, 80, 81, 82, 83, 84, 85, 86, 87, 88, 89, 90, 91, 92, 93, 94, 95, 96, 97, 98, 99, 100, 101, 102, 103, 104, 105, 106, 107, 108, 109, 110, 111, 112, 113, 114, 115, 116, 117, 118, 119, 120, 121, 122, 123, 124, 125, 126, 127, 128, 129, 130, 131, 132, 133, 134, 135, 136, 137, 138, 139, 140, 141, 142, 143, 144, 145, 146, 147, 148, 149, 150, 151, 152, 153, 154, 155, 156, 157, 158, 159, 160, 161, 162, 163, 164, 165, 166, 167, 168, 169, 170, 171, 172, 173, 174, 175, 176, 177, 178, 179, 180, 181, 182, 183, 184, 185, 186, 187, 188, 189, 190, 191, 192, 193, 194, 195, 196, 197, 198, 199, 200, 201, 202, 203, 204, 205, 206, 207, 208, 209, 210, 211, 212, 213, 214, 215, 216, 217, 218, 219, 220, 221, 222, 223, 224, 225, 226, 227, 228, 229, 230, 231, 232, 233, 234, 235, 236, 237, 238, 239, 240, 241, 242, 243, 244, 245, 246, 247, 248, 249, 250, 251, 252, 253, 254, 255, 256, 257, 258, 259, 260, 261, 262, 263, 264, 265, 266, 267, 268, 269, 270, 271, 272, 273, 274, 275, 276, 277, 278, 279, 280, 281, 282, 283, 284, 285, 286, 287, 288, 289, 290, 291, 292, 293, 294, 295, 296, 297, 298, 299, 300, 301, 302, 303, 304, 305, 306, 307, 308, 309, 310, 311, 312, 313, 314, 315, 316, 317, 318, 319, 320, 321, 322, 323, 324, 325, 326, 327, 328, 329, 330, 331, 332, 333, 334, 335, 336, 337, 338, 339, 340, 341, 342, 343, 344, 345, 346, 347, 348, 349, 350, 351, 352, 353, 354, 355, 356, 357, 358, 359, 360, 361, 362, 363, 364, 365, 366, 367, 368, 369, 370, 371, 372, 373, 374, 375, 376, 377, 378, 379, 380, 381, 382, 383, 384, 385, 386, 387, 388, 389, 390, 391, 392, 393, 394, 395, 396, 397, 398, 399, 400, 401, 402, 403, 404, 405, 406, 407, 408, 409, 410, 411, 412, 413, 414, 415, 416, 417, 418, 419, 420, 421, 422, 423, 424, 425, 426, 427, 428, 429, 430, 431, 432, 433, 434, 435, 436, 437, 438, 439, 440, 441, 442, 443, 444, 445, 446, 447, 448, 449, 450, 451, 452, 453, 454, 455, 456, 457, 458, 459, 460, 461, 462, 463, 464, 465, 466, 467, 468, 469, 470, 471, 472, 473, 474, 475, 476, 477, 478, 479, 480, 481, 482, 483, 484, 485, 486, 487, 488, 489, 490, 491, 492, 493, 494, 495, 496, 497, 498, 499, 500, 501, 502, 503, 504, 505, 506, 507, 508, 509, 510, 511, 512, 513, 514, 515, 516, 517, 518, 519, 520, 521, 522, 523, 524, 525, 526, 527, 528, 529, 530, 531, 532, 533, 534, 535, 536, 537, 538, 539, 540, 541, 542, 543, 544, 545, 546, 547, 548, 549, 550, 551, 552, 553, 554, 555, 556, 557, 558, 559, 560, 561, 562, 563, 564, 565, 566, 567, 568, 569, 570, 571, 572, 573, 574, 575, 576, 577, 578, 579, 580, 581, 582, 583, 584, 585, 586, 587, 588, 589, 590, 591, 592, 593, 594, 595, 596, 597, 598, 599, 600, 601, 602, 603, 604, 605, 606, 607, 608, 609, 610, 611, 612, 613, 614, 615, 616, 617, 618, 619, 620, 621, 622, 623, 624, 625, 626, 627, 628, 629, 630, 631, 632, 633, 634, 635, 636, 637, 638, 639, 640, 641, 642, 643, 644, 645, 646, 647, 648, 649, 650, 651, 652, 653, 654, 655, 656, 657, 658, 659, 660, 661, 662, 663, 664, 665, 666, 667, 668, 669, 670, 671, 672, 673, 674, 675, 676, 677, 678, 679, 680, 681, 682, 683, 684, 685, 686, 687, 688, 689, 690, 691, 692, 693, 694, 695, 696, 697, 698, 699, 700, 701, 702, 703, 704, 705, 706, 707, 708, 709, 710, 711, 712, 713, 714, 715, 716, 717, 718, 719, 720, 721, 722, 723, 724, 725, 726, 727, 728, 729, 730, 731, 732, 733, 734, 735, 736, 737, 738, 739, 740, 741, 742, 743, 744, 745, 746, 747, 748, 749, 750, 751, 752, 753, 754, 755, 756, 757, 758, 759, 760, 761, 762, 763, 764, 765, 766, 767, 768, 769, 770, 771, 772, 773, 774, 775, 776, 777, 778, 779, 780, 781, 782, 783, 784, 785, 786, 787, 788, 789, 790, 791, 792, 793, 794, 795, 796, 797, 798, 799, 800, 801, 802, 803, 804, 805, 806, 807, 808, 809, 810, 811, 812, 813, 814, 815, 816, 817, 818, 819, 820, 821, 822, 823, 824, 825, 826, 827, 828, 829, 830, 831, 832, 833, 834, 835, 836, 837, 838, 839, 840, 841, 842, 843, 844, 845, 846, 847, 848, 849, 850, 851, 852, 853, 854, 855, 856, 857, 858, 859, 860, 861, 862, 863, 864, 865, 866, 867, 868, 869, 870, 871, 872, 873, 874, 875, 876, 877, 878, 879, 880, 881, 882, 883, 884, 885, 886, 887, 888, 889, 890, 891, 892, 893, 894, 895, 896, 897, 898, 899, 900, 901, 902, 903, 904, 905, 906, 907, 908, 909, 910, 911, 912, 913, 914, 915, 916, 917, 918, 919, 920, 921, 922, 923, 924, 925, 926, 927, 928, 929, 930, 931, 932, 933, 934, 935, 936, 937, 938, 939, 940, 941, 942, 943, 944, 945, 946, 947, 948, 949, 950, 951, 952, 953, 954, 955, 956, 957, 958, 959, 960, 961, 962, 963, 964, 965, 966, 967, 968, 969, 970, 971, 972, 973, 974, 975, 976, 977, 978, 979, 980, 981, 982, 983, 984, 985, 986, 987, 988, 989, 990, 991, 992, 993, 994, 995, 996, 997, 998, 999, 1000

Professional seal of a surveyor, including the name and title of the professional.

PENINSULA UNITS 74 THRU 83

PENINSULA UNITS 84 THRU 93

PENINSULA UNITS 94 THRU 103

PENINSULA UNITS 104 THRU 113

PENINSULA UNITS 114 THRU 123

PENINSULA UNITS 124 THRU 133

PENINSULA UNITS 134 THRU 143

PENINSULA UNITS 144 THRU 153

PENINSULA UNITS 154 THRU 163

PENINSULA UNITS 164 THRU 173

PENINSULA UNITS 174 THRU 183

PENINSULA UNITS 184 THRU 193

PENINSULA UNITS 194 THRU 203

PENINSULA UNITS 204 THRU 213

PENINSULA UNITS 214 THRU 223

PENINSULA UNITS 224 THRU 233

PENINSULA UNITS 234 THRU 243

PENINSULA UNITS 244 THRU 253

PENINSULA UNITS 254 THRU 263

PENINSULA UNITS 264 THRU 273

PENINSULA UNITS 274 THRU 283

PENINSULA UNITS 284 THRU 293

PENINSULA UNITS 294 THRU 303

PENINSULA UNITS 304 THRU 313

PENINSULA UNITS 314 THRU 323

PENINSULA UNITS 324 THRU 333

PENINSULA UNITS 334 THRU 343

PENINSULA UNITS 344 THRU 353

PENINSULA UNITS 354 THRU 363

PENINSULA UNITS 364 THRU 373

PENINSULA UNITS 374 THRU 383

PENINSULA UNITS 384 THRU 393

PENINSULA UNITS 394 THRU 403

PENINSULA UNITS 404 THRU 413

PENINSULA UNITS 414 THRU 423

PENINSULA UNITS 424 THRU 433

PENINSULA UNITS 434 THRU 443

PENINSULA UNITS 444 THRU 453

PENINSULA UNITS 454 THRU 463

PENINSULA UNITS 464 THRU 473

PENINSULA UNITS 474 THRU 483

PENINSULA UNITS 484 THRU 493

PENINSULA UNITS 494 THRU 503

PENINSULA UNITS 504 THRU 513

PENINSULA UNITS 514 THRU 523

PENINSULA UNITS 524 THRU 533

PENINSULA UNITS 534 THRU 543

PENINSULA UNITS 544 THRU 553

PENINSULA UNITS 554 THRU 563

PENINSULA UNITS 564 THRU 573

PENINSULA UNITS 574 THRU 583

PENINSULA UNITS 584 THRU 593

PENINSULA UNITS 594 THRU 603

PENINSULA UNITS 604 THRU 613

PENINSULA UNITS 614 THRU 623

PENINSULA UNITS 624 THRU 633

PENINSULA UNITS 634 THRU 643

PENINSULA UNITS 644 THRU 653

PENINSULA UNITS 654 THRU 663

PENINSULA UNITS 664 THRU 673

PENINSULA UNITS 674 THRU 683

PENINSULA UNITS 684 THRU 693

PENINSULA UNITS 694 THRU 703

PENINSULA UNITS 704 THRU 713

PENINSULA UNITS 714 THRU 723

PENINSULA UNITS 724 THRU 733

PENINSULA UNITS 734 THRU 743

PENINSULA UNITS 744 THRU 753

PENINSULA UNITS 754 THRU 763

PENINSULA UNITS 764 THRU 773

PENINSULA UNITS 774 THRU 783

PENINSULA UNITS 784 THRU 793

PENINSULA UNITS 794 THRU 803

PENINSULA UNITS 804 THRU 813

PENINSULA UNITS 814 THRU 823

PENINSULA UNITS 824 THRU 833

PENINSULA UNITS 834 THRU 843

PENINSULA UNITS 844 THRU 853

PENINSULA UNITS 854 THRU 863